

Subject to change

Document Ref:
FBJ-710/17567/PMR13/Issue 1/Mar 02

Copyright ©
These instructions are the sole property of Ferm-Omega Tools and may not be reproduced

USER'S MANUAL

Ferm Biscuit Jointer

FBJ-710



Ferm[®]

Art.nr. 726750
Screwfix nr. 17569

**FERM FBJ-710 BISCUIT JOINTER
USERS MANUAL**

TECHNICAL SPECIFICATIONS

Voltage	230 V~
Frequency	50 Hz
Power input	710 W
No-load speed	11000/min
Disc diameter	100 mm
Blade bore diameter	20 mm
Max. cutting depth	22 mm
Fence adjustment	0 - 90°
Spindle dimension	M10
Weight	3.0 kg
Lpa (sound pressure)	89.6 dB(A)
Lwa (sound power level)	102.6 dB(A)
Vibration value	1.9 m/s ²

PACKAGE CONTENTS

- The package contains:
- | Biscuit jointer
 - | Saw blade
 - | Wrench
 - | Adjustment plate
 - | Allen wrench
 - | Dust collection bag
 - | Instruction manual
 - | Safety instructions
 - | Guarantee card

PRODUCT INFORMATION

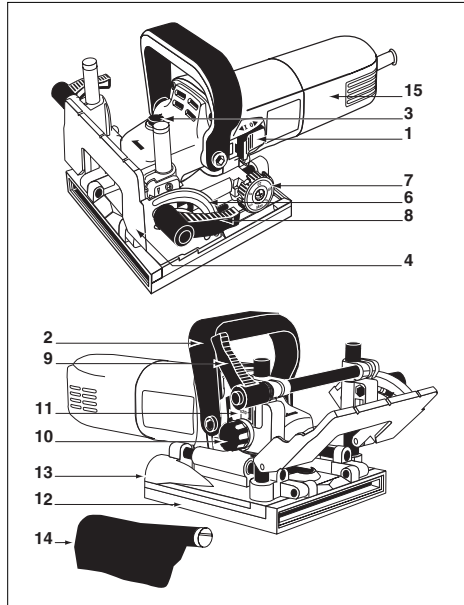

Fig. A

The FBJ-710 Biscuit Jointer is suitable for cutting grooves for biscuit dowel joints in solid wood, plywood, chipboard, fibre board, plexiglass and artificial marble.

1. On/off switch
2. Auxiliary handle
3. Spindle lock
4. Angle stop
6. Scale for the fence angle
7. Cutting depth adjustment knob
8. Clamping lever for angle adjustment
9. Clamping lever for height adjustment
10. Knob for height adjustment
11. Scale for the height adjustment
12. Base plate
13. Dust bag connection
14. Dust bag
15. Motor base

SAFETY INSTRUCTIONS

The following symbols are used throughout this manual:



Denotes risk of personal injury, loss of life or damage to the tool in case of non-observance of the instructions in this manual.



Denotes risk of electric shock

SPARE PARTS LIST

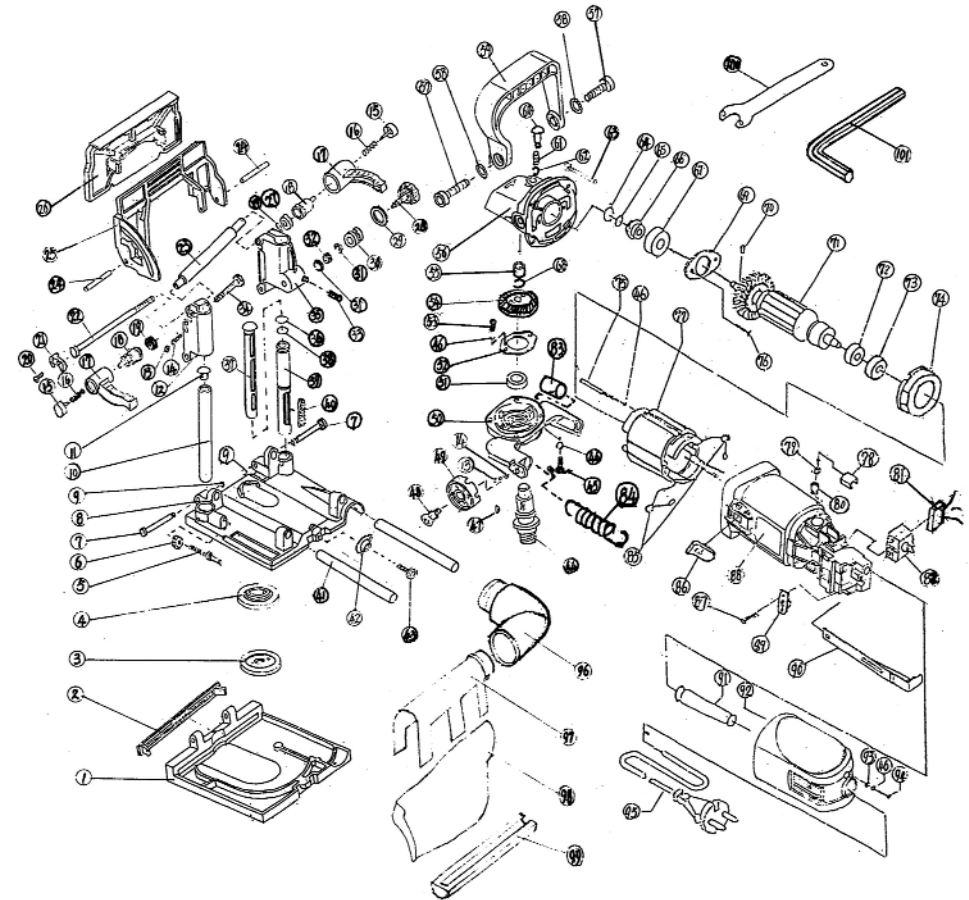

SPARE PARTS LIST

POS.	DESCRIPTION	FERMET-NR.
407650	UPPER FLANGE	003
407651	LOWER FLANGE	004
407652	STOPPED PIN + NUT	005 + 006
407653	LOCKING KNOB COMPLETE	015 - 019
407655	ADJUSTING KNOB	028
407658	SPINDLE GEAR	054
407659	HANDLE	059
407660	PINION GEAR	066
406059	ROTOR	071
406060	STATOR	077
406061	CARBON BRUSH SET	079
406062	CARBON BRUSH HOLDER	080
406063	SWITCH	082
406064	SWITCH ACTUATOR	086
406065	PULL-ROD FOR SWITCH	090
407661	DUST BAG COMPLETE	096 - 099
407662	WRENCH	100

Carefully read this manual before using the machine. Make sure that you know how the machine functions and how to operate it. Maintain the machine in accordance with the instructions to make sure it functions properly. Keep this manual and the enclosed documentation with the machine.

Ferm products are manufactured to high quality standards, they are safe and fit for purpose at time of sale, but all tools can be dangerous if the correct precautions are not taken. Always follow these instructions, do not carry out the operation until you are sure you can do so in safety. Remember to consider the work environment for safe operation as well as safety for tool use.



Warning! When using electric tools, basic safety precautions should always be followed to reduce the risk of fire, electric shock and personal injury. Read all these instructions before attempting to operate this product. Save these instructions for future reference.

PERSONAL SAFETY

Use Personal Protection Safety Equipment

Protect eyes with safety glasses or goggles note: the use of safety protective eyewear without the CE mark can lead to serious injury if the lens breaks. A suitable dust mask should be worn if cutting, drilling or sanding is dusty, in particular chipboard or MDF. Approved safety footwear and headgear should worn as appropriate, for example on building works or when heavy weights are involved. Wear suitable gloves and apron to protect against sparks/debris. Wear earplugs or ear defenders.

Dress properly

Do not wear loose clothing or jewellery. It can get caught in moving parts. Non-skid footwear is recommended when working out doors. Wear protective hair covering to contain long hair

Stay alert

Watch what you are doing Use common sense. Do not operate tools when tired or after taking alcohol or prescription/ non-prescription drugs.

OPERATIONAL SAFETY



Warning! Be aware this machine can produce fine dust, which can be hazardous to your health. Always wear a suitable protective mask and use dust extraction.

Concentrate

Routine and repetition can lead to mistakes. Remember that a slight lack of concentration can result in serious injuries in a split second.

Keep work area clean

Cluttered areas and benches invite injuries.

Consider the work environment

Do not expose power tools to rain or use them in damp or wet locations. Keep work area well lit. Do not use power tools in the presence of flammable liquids, vapours or gases.

Guard against electric shock

This unit contains dangerous voltages. Use a RCD (residual current device) to provide protection against electrical shock. Prevent body contact with grounded surfaces (e.g. pipes, radiator, ranges or refrigerators).

Keep children and pets away

Do not let children or pets come into contact with the tool, extension cable or work area.

Do not force the tool

It will work better and safer at the rate for which it was intended.

Use the right tool

Do not force small tools or attachments to do the job of a heavy-duty tool. Do not use tools for purposes for which they were not intended; for example do not use a circular saw for cutting trees or logs.

Do not abuse the cable

Never carry the tool by the cable or pull it to disconnect it from the power socket. Keep the cable away from heat, oil and sharp edges. Do not touch the metal plug pins when connecting or removing the plug.

Secure Work

Use clamps or a vice to hold work. It is safer than using your hand and it frees both hands to operate the tool. Be aware that this jointer is a powerful machine; you must use two hands to control it.

Do not over-reach

Keep a proper footing and balance at all times.

Disconnect tools from power supply

When not in use, before servicing and when changing accessories such as blades, bits and cutters. **Always switch off and unplug the jointer from the power supply before making adjustments or changing blades.**

Remove adjusting keys and wrenches

Ensure that they are removed from the tool before switching on.

Avoid unintentional starting

Do not carry plugged in tools with your finger on the switch. Check that the switch is off before plugging in to socket.

Extension cables

Use only three core earthed extension cables suitable for the power input of the tool (minimum cable size 1.5mm²). Plug into an earthed socket only. When using a cable reel unwind it fully. Do not use long extension cables.

Outdoors use

If the tool is suitable to be used outdoors, only use an extension cable intended for outdoor use and marked accordingly. Use a RCD (residual current device) to provide protection against electrical shock. Do not use in rain or damp conditions.

Connect a dust extraction device

Whenever there are facilities for fitting a dust or fume extraction system, make sure it is connected and used.

Use recommended accessories

The use of any other accessory or attachment other than recommended in the instructions or catalogue may present a risk of personal injury. Use extension cables suitable for the power input of the saw (minimum cable size 1.5mm²). When using a cable reel unwind the cable fully.

BEFORE USING THE JOINTER



Ensure the machine is switched OFF and unplugged from mains before changing parts or accessories, adjusting or inspecting this machine.

CHANGING/FITTING SAW BLADES

Refer to illustration below

- Loosen the Allen screw (16) with the 4mm wrench supplied and open the top of the base plate.
- Press the spindle lock button and turn the spindle (17) until it locks. Keep the spindle lock button depressed.
- Remove the flange nut (18) anticlockwise and the saw blade (if fitted) using the wrench (19) supplied.
- Make sure the flange washer is the right way up to suit the new blade - one side is for 20mm bore blades and the other is for 22mm.
- Check that the lugs on the flange washer engage with the flats on the spindle.
- Check the saw blade is on the right way up - cutting edge of the teeth should follow the arrow marked on the saw base.
- Put the new saw blade (20) onto the flange washer then tighten the flange nut securely clockwise with the wrench.
- Release the spindle lock button and check the spindle is free by rotating it.
- Close the top of the base plate, and screw in the Allen screw with washer attached, making sure the washer is located over the domed part on the saw base. Tighten securely with the Allen wrench.

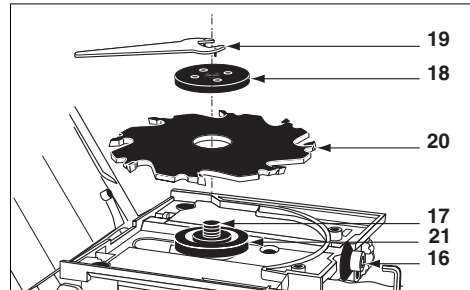

CHECKING THE MAXIMUM CUTTING DEPTH

After changing/fitting a saw blade always check the maximum cutting depth.

Refer to illustration below.

- Check that the motor body (15) is back as far as possible.
- Set the adjustment knob (7) to the 'MAX' position
- Hold the saw base and move the motor body forwards until the pin (A) enters the notch in the knob.
- Turn the saw blade so a tooth tip is on the centreline.
- Measure the distance between the tip of the saw tooth and the side of the saw base. The maximum measurement is 18mm, if it isn't you will need to set the cutting depth.

SETTING THE CUTTING DEPTH

- Move the motor body (15) backwards as far as it will go.
- Loosen pin (A) and its lock nut.
- Check knob (7) is set to 'MAX' position.
- Set the cutting depth by checking the distance and turning the pin as required. When the distance is correct, lock the pin with its lock nut and tighten.

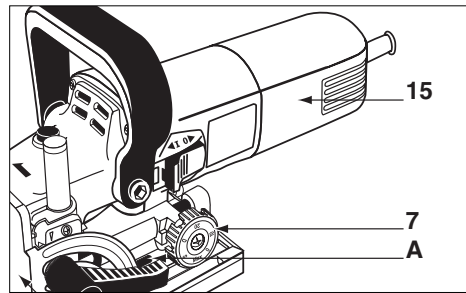

ADJUSTING THE HEIGHT

Refer to illustration below.

- Set the height by unlocking the clamping lever (9) (turn anticlockwise), and turning the height adjustment knob (10) to set the required height on scale (11).
- The correct height is half the thickness of the workpiece - the groove for the biscuit dowel should be in the middle of the workpiece.
- After you have set the height, securely lock the lever by turning clockwise, if the lever is in the way in that position, pull it outwards and rotate to a better position without unscrewing the adjustment clamp.

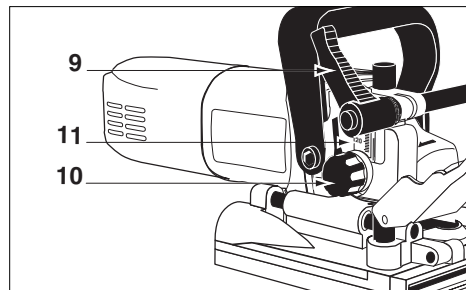

GUARANTEE

The guarantee conditions can be found on the separately enclosed guarantee card.

CE DECLARATION OF CONFORMITY (UK)

We declare under our sole responsibility that this product is in conformity with the following standards or standardized documents

**EN50144-1, EN55014-1, EN-55014-2,
EN61000-3-2, EN61000-3-3**

in accordance with the regulations.

**98/37EEC, 73/23EEC,
89/336EEC**

from 03-01-2001
GENEMUIDEN NL
W. Kamphof
Quality department

TO ADJUST THE CUTTING DEPTH

Referring to the illustration below.

- Move the motor body backwards as far as it will go, then turn the adjustment knob (7) to the required setting (see chart below).
- Move the motor base forwards and check that pin (A) engages in the notch.

Knob marking	Thickness of material	Biscuit Dowel	Cutting depth in mm.
0	8-12 mm	No.0	8.0
10	12-15 mm	No. 10	10.0
20	> 15 mm	No.20	12.3
S	-	Simplex	13.0
D	-	Duplex	14.7
Max.	-	-	18.0

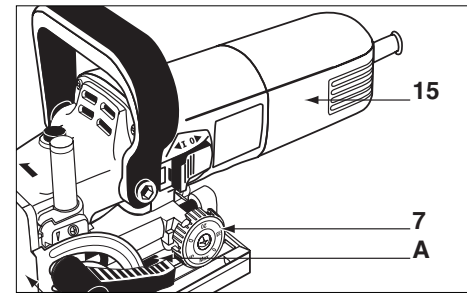

ADJUSTING THE CUTTING ANGLE

Referring to the illustration below.

- Set the cutting angle by unlocking the clamping lever (8) (turn anticlockwise), and rotating the angle stop (4) to the required angle indicated on the quadrant scale.
- After you have set the cutting angle, securely lock the lever by turning clockwise, if the lever is in the way in that position, pull it outwards and rotate to a better position without unscrewing the adjustment clamp.

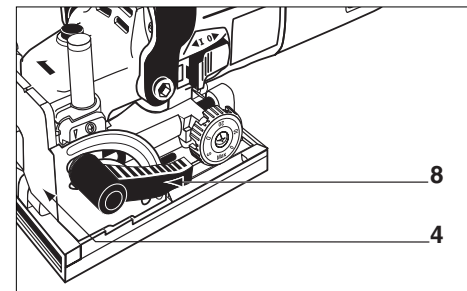

ATTACHING THE DUST BAG/DUST EXTRACTION

- Insert the dust bag with its adaptor into the nozzle on the right hand side of the jointer base. Empty the bag frequently during use.
- The nozzle on the jointer base can also be used for connection to vacuum dust extraction unit – not supplied.
- **Be aware this machine can produce fine dust, which can be hazardous to your health. Always wear a suitable protective mask and use dust extraction.**

USING THE BISCUIT JOINTER



This jointer is intended for use on wood, wood derived and plastic products only

BEFORE OPERATING

- Check the voltage on the jointer corresponds with your power supply voltage and that the plug and lead are in good condition.
- Check you have the correct type of saw blade for the machine, that it is suitable for the spindle speed of the jointer and that it is mounted correctly.
- Do not use cutting discs or circular saw blades in this machine.
- Do not use parts other than supplied with the machine to make the blade fit properly.
- Check you have a blade suitable for the material being cut and that it is in good condition. If any teeth are missing or the blade shows cracks or other damage – replace immediately.
- Run idle for 30 seconds - if there is any abnormal vibration or other fault – switch off, inspect and rectify before continuing.

OPERATION

- Plug into a suitable mains supply and switch on.
- **Be aware that this machine has a powerful motor and needs two hands to operate it safely.**
- To switch the jointer ON Slide the ON/OFF switch forwards.
- To switch OFF Depress the ON/OFF switch – the switch will automatically move to the OFF position.

DURING USE

- Place the base/angle stop gently but firmly onto the work piece and let the blade come to full speed before cutting the work piece – this is a powerful machine and will kick if the blade is pressed too hard or jammed in the cut. Always use two hands to control the machine.
- Keep the base/angle stop in firm contact with the workpiece.
- Do not force the jointer. Move gently and steadily along the line of cut.
- Check material for foreign bodies
- For example check for nails screws etc.
- Clamp material properly. Do not use hand or foot to support the work piece. Saw away from yourself.
- Use constant gentle pressure.

- If the blade seizes in the cut, switch off, unplug and open the cut with a suitable tool before pulling the blade out – never switch the jointer on with the blade jammed.
- Do not put the machine down with the motor still running.
- Regularly inspect the blade (unplug first) during use for signs of damage or wear and replace when required.
- Switch the machine off before removing the plug from the mains socket.
- Be careful. Do not point the jointer at yourself or other people. Keep your hands away from the blade.

MARKING THE WORKPIECES

Before using the jointer the workpieces must be marked. Refer to illustration below

- Place the two workpieces, which are to be joined on top of each other.
- Clamp the workpieces and mark the centre of the groove.
- The space between the two grooves should be 10–15mm, this doesn't apply to smaller workpieces, which don't have to be marked.

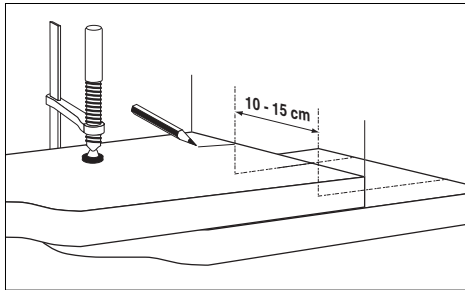

POSITIONING THE MACHINE

Based on the size of the workpiece the jointer can be positioned in several ways:

Large workpieces

- Place the machine on the workpiece and line up the centre point marked on the base plate with the centre of the groove as in illustration below.

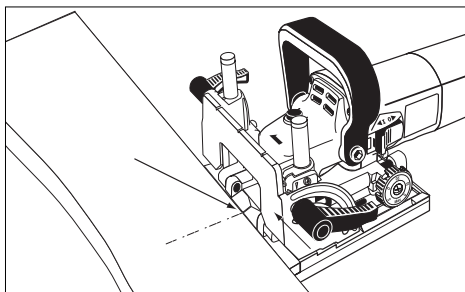

Small workpieces

- Place the machine on the workpiece; the side of the machine must face the side of the workpiece as illustrated below.

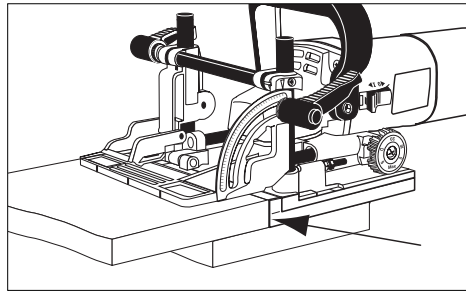

Thin workpieces (less than 16mm)

- Place the machine on the workpiece as illustrated below. Place the adjustment plate (5) on the angle stop (4).
- Take care setting the height; the groove must be in the centre of the workpiece.

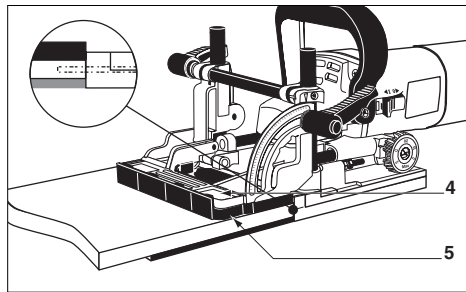

Sawing grooves

- Move the motor body backwards
- Position the machine on the workpiece.
- Hold the machine with both hands and switch ON.
- Push the motor base carefully forward as far as it will go and complete the cut.
- Move the motor body backwards and switch OFF.
- Joining the workpieces
- When the grooves in both pieces have been cut they can be joined.
- Put glue into both grooves.
- Place the correct size biscuit dowel into one side.
- Push the other side onto the dowel and cramp until the glue is dry.

MAINTENANCE, CARE AND REPAIR



Switch off and unplug the machine before carrying out cleaning, adjusting or changing blades.

CLEANING

Do not use flammable liquids to clean the jointer.

FAULTS

Switch OFF immediately at the mains plug and remove the plug when:

- The plug or cable is damaged.
- The switch on the machine is defective.
- You smell or see smoke caused by scorched insulation in the machine.

The motor runs hot (over 70°C)

- The motor has been overloaded, cut more slowly.
- The motor is defective; take to your local dealer for repair.

The jointer does not work when switched on

- Damaged plug/fuse, replace as required.
- Defective switch, take to local dealer for repair.

The jointer does not cut cleanly and/or wanders off line

- The blade is blunt or bent, replace blade with suitable resharpened or new one.

The saw makes a lot of noise and does not run smoothly

- Take to your local dealer for inspection or repair.

There are no user serviceable/repairable parts inside this unit. Qualified service engineers must carry out repair and servicing.

MAINTAIN TOOLS WITH CARE

Keep the tool clean for better and safer performance. Store the blades properly in accordance with the maker's instructions.

Follow instructions for changing accessories. Inspect tool and extension cables periodically and if damaged, have them repaired by a qualified person or authorised service body. Keep handles free from oil or grease. Keep the ventilation slots clean to prevent the motor overheating.

Check for damaged parts

Do not use a tool with damaged parts, before further use a damaged tool must be carefully checked by a qualified person to determine that it will operate properly. Check for alignment of moving parts, binding or breakage of parts, mounting and other conditions that may affect its operation. A damaged part or guard should be properly repaired by an authorised service centre, unless indicated otherwise in the instruction manual. Have defective switches replaced by an authorised service centre. Do not use a tool if the switch does not turn on and off.

Have your tool repaired by an expert

This appliance is manufactured in accordance with relevant safety standards. Only experts must carry out repairing of electrical appliances, otherwise considerable danger for the user may result.

Storing tools

When not in use tools should be stored in the dry, out of reach of children.

Lubrication

The machine requires no user lubrication

ELECTRICAL INFORMATION

This product is complete with a pre-wired mains plug, it is double insulated in accordance with EN 50144 – no earth wire is required. If the plug needs replacing follow these instructions.

Wire correctly

The wires in the mains lead are coloured in the following way:

BLUE -Neutral
BROWN -Live

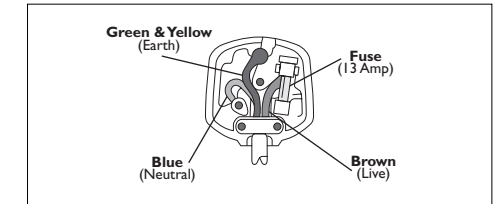

Securing wires

Secure wires carefully and firmly to the correct terminals. Secure the mains cable in the plug cord grip firmly. Fit a 13-amp fuse. If a 13amp (BS1363) plug is used a (BS1362) ASTA approved 5-amp fuse must be fitted.

Recycle/Dispose of old plug and cable

Prevent inadvertent connection to socket and risk of electric shock.

ENVIRONMENT

Recycle the packaging according to the identification marks on it.

At the end of the product or its accessories life please recycle where facilities exist - phone the Helpline for current advice on recycling.

Helpline

For any questions relating to operational or safety matters contact:

Ferm Customer Helpline on: **0115 966 1199**
Monday to Friday **8am - 6pm**
Saturday **9am - 1pm**